



DAWSON
CONSTRUCTION PLANT LTD

CRANE SUSPENDED VIBRATOR - CSV550

WORLDWIDE
DEALER
NETWORK

GLOBAL
SUPPLY,
LOCAL
SUPPORT.

DAWSON CONSTRUCTION PLANT
CHESNEY WOLD,
BLEAK HALL,
MILTON KEYNES,
MK6 1NE
ENGLAND

TEL. +44 1908 240300
FAX. +44 1908 240222
EMAIL. DAWSON@DCPUK.COM

www.dcpuk.com

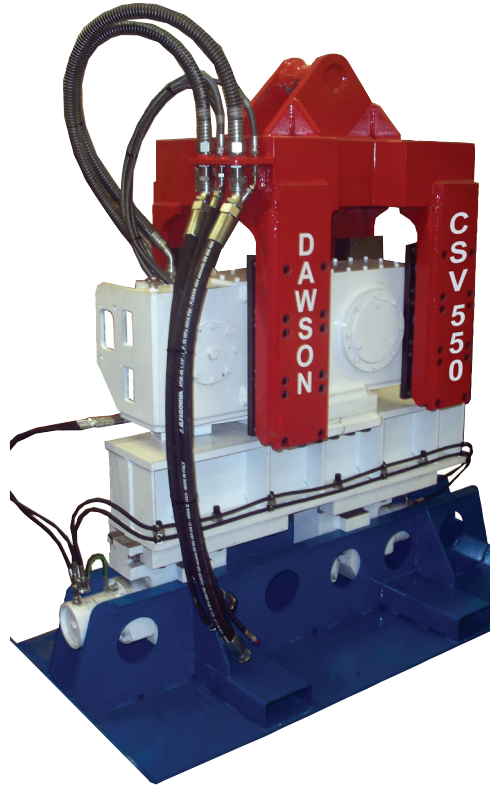

SPECIFICATION	UNITS	Vibro Model
		CSV550
STATIC MOMENT	in.lbs	674
	kgm	8.3
FREQUENCY	vpm	2,500
CENTRIFUGAL FORCE	lbs	125,592
	kN	550
AMPLITUDE - PEAK TO PEAK	ins	0.51
	mm	13
MINIMUM REQUIRED FLOW RATE	gpm	68
	l/min	256
MAXIMUM ALLOWABLE FLOW RATE	gpm	107
	l/min	400
MINIMUM HYDRAULIC MOTOR PRESSURE	psi	3,625
	bar	280
MAXIMUM HYDRAULIC MOTOR PRESSURE	psi	5,076
	bar	350
MINIMUM HYDRAULIC MOTOR POWER	hp	160
	kW	120
DYNAMIC MASS	lbs	2,376
	kg	1,080
TOTAL MASS	lbs	5236
	kg	2,380
MAXIMUM PILE MASS	lbs	3,136
	kg	1,400
MAXIMUM PUSH/PULL LOADING	lbs	49,500
	kg	22,500
CLAMP FORCE	Tonne	66

UNIVERSAL CLAMP - 416kg
CASSION BEAM WITH CLAMPS - 670kg
TOTAL MASS INCLUDING UNIVERSAL CLAMP - 2380kg

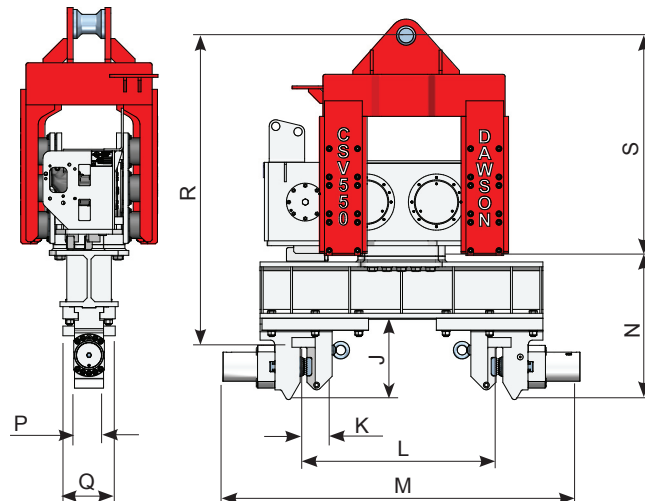
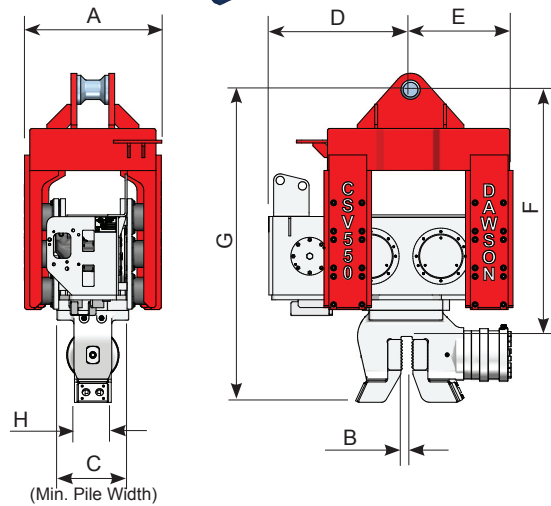

DIMENSIONS mm (inch)	
A	705 (27.7)
B	50 (1.97)
C	268 (10.4)
D	732 (28.8)
E	529 (20.8)
F	1274 (50.2)
G	1614 (63.5)
H	195 (7.7)
J	450 (17.7)
K	147.5 (5.8)
L	NOMINAL JAW CTRS 300 (11.8) MIN 1100 (43.3) MAX
M	1865 (73.5) FULLY OUT 1320 (52) FULLY IN
N	735 (29)
P	158 (6.2)
Q	250 (9.85)
R	1472 (58)
S	1002 (39.5)



DAWSON
CONSTRUCTION PLANT LTD

CRANE SUSPENDED VIBRATOR - CSV550

DAWSON CONSTRUCTION PLANT
CHESNEY WOLD,
BLEAK HALL,
MILTON KEYNES,
MK6 1NE
ENGLAND

TEL. +44 1908 240300
FAX. +44 1908 240222

EMAIL. DAWSON@DCPUK.COM

www.dcpuk.com

This Dawson power pack is fully self contained, including all oil and fuel reservoirs, prime mover and hydraulic circuitry. The power pack is designed to be directly connected to the working element of the system; however it can be connected through further hydraulic valves to perform alternative operations with guidance from the manufacturer. The power pack is designed to produce a fixed oil

flow rate at a pre-set pressure to supply hydraulic piling hammers in various environments from hot summers in Kuwait to cold winters in Ontario. The diesel engine runs at a fixed RPM and is calibrated against the pump flow rate. A built in offline filtration system is used to condition the hydraulic oil to 2 microns and remove an amount of water contamination.

HOT METAL SPRAYED PRIOR TO
OFFSHORE SPEC. POWDER COATING.



PARKER PV+140cc
HYDRAULIC PUMP

CATERPILLAR C6.6 ACERT® - 6 CYLINDER
DIESEL MOTOR WITH TURBOCHARGER
AND INTER-COOLING.

SPECIFICATION	UNITS	DHP170
DIESEL ENGINE POWER	kW	168
	rpm	2200
HYDRAULIC SYSTEM PRESSURE	bar	270
	psi	3915
OIL FLOW RATE	l/min	270
SIZE - LENGTH x WIDTH x HEIGHT	m	3.8 x 1.5 x 2
	ins	149 x 59 x 78
WEIGHT	kg	4800
	lbs	10,560
FUEL CAPACITY	litres	460
FUEL CONSUMPTION @ 60%	litres / hour	28

